

St Gemma's
Hospice Charity
Shop

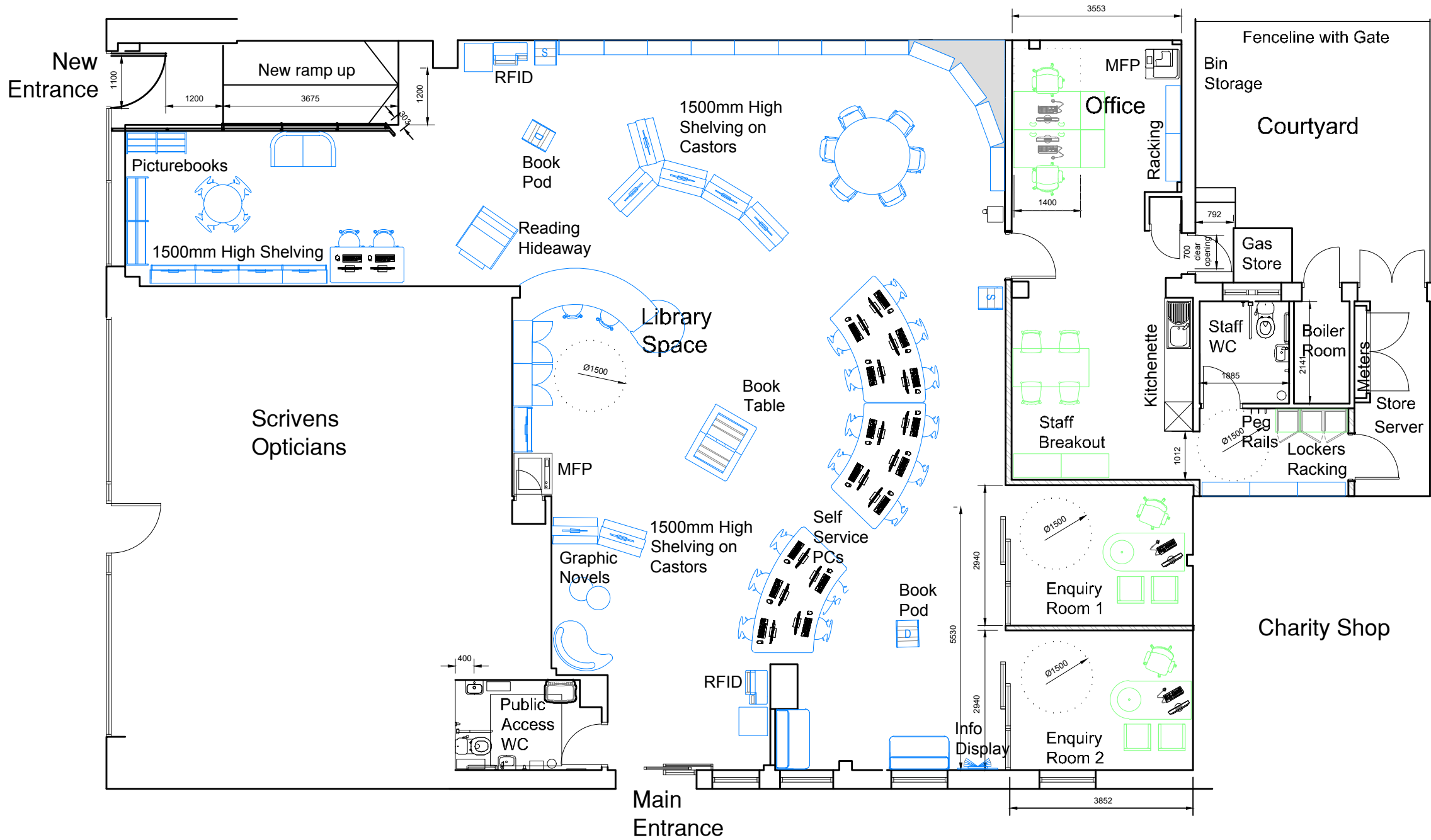

Notes:

Loose and Fixed Furniture shown in Blue:
Library furniture by Opening the Book (not in Contract).

Loose Furniture shown in Green:
Office and meeting room furniture, including bins, existing and new, to be supplied by the Client (not in the Contract).

Equipment shown in grey:
Equipment such as PCs, keyboard, mouse, screen, MFP, Comms cabinet, till etc, supplied by the Client (not in the Contract)

Fixed items such as coat hooks, baby change unit, sanitaryware, sink, kitchen units, worktop and splashback, water, boiler are to be included in the Contract. Please see finishes schedule and spec.

White goods such as water dispenser, fridge and microwave to be supplied by the Client (not in Contract). Fitted by Contractor.

Toilet roll holder, paper towel holder and soap dispenser are to be supplied and fitted by Client. Hand dryers to be supplied and fitted by Contractor.

MFP- Multi functional printer
Supplied by client.

RFID- Radio-frequency identification
Supplied by client.

THIS DRAWING IS PRODUCED FOR USE IN THIS PROJECT ONLY AND MAY NOT BE USED FOR ANY OTHER PURPOSE. NPS PROPERTY CONSULTANTS LTD ACCEPT NO LIABILITY FOR THE USE OF THIS DRAWING OTHER THAN THE PURPOSE FOR WHICH IT WAS INTENDED IN CONNECTION WITH THIS PROJECT AS RECORDED IN THE 'PURPOSE FOR ISSUE' AND 'FILE STATUS CODE'.

THIS DRAWING MAY NOT BE REPRODUCED IN ANY FORM WITHOUT PRIOR WRITTEN AGREEMENT OF NPS PROPERTY CONSULTANTS LTD.

© CROWN COPYRIGHT AND DATABASE RIGHTS 2020
ORDNANCE SURVEY LICENCE NUMBER 100022264

ORIGINAL
SHEET SIZE
A3

P1: 06.09.2019: GE; FIRST ISSUE. Draft proposal pending structural information.
P1.1 04.11.2019: GE; Staff breakout area layout changed slightly. Staff WC door left opening inwards. OTB furniture layout added.
P1.2 10.12.2019: CAB; Handrail added. OTB furniture revised slightly to suit handrail and drawf wall.
P2: New hand wash basin and baby change in public acces WC changed positon.

REV	DRAWN	DATE	CHECKED	DATE	APPROVED	DATE
P2	GE	20.12.2019	CAB	20.12.2019	NB	10.12.2019
COMMENT						

CLIENT
**Leeds City Council
Communities &
Environment**

PROJECT
Beeston Community Hub

TITLE
**Proposed Furniture,
Fixtures and Equipment
(FF&E) Plan**



NPS Leeds Ltd
Unit 3a, First Floor, Evolution House,
Springwell Road, Holbeck, Leeds, LS12 1AW,
Tel: 0113 320 1630; Email: leeds@nps.co.uk;
web:www.nps.co.uk

SCALES	DISCIPLINE	PROJECT NUMBER
1:100	INT DSGN	100457
DRAWING NUMBER		REV CODE
NPS-DR-I -(81)-031		P 2
STATUS CODE	PURPOSE OF ISSUE	DRAWN
D2	TENDER	CAB